

Color	Type	Technology	Electrodes
Yellow	Point source, 150 µm	AllnGaP/GaAs	N (cathode) up

Outline (dimensions in microns)

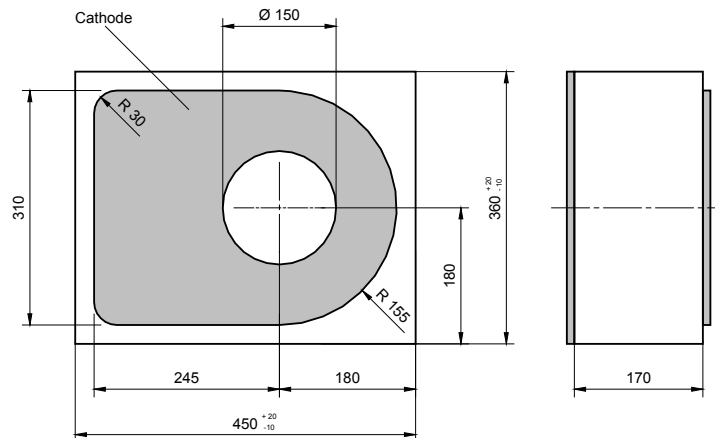

Maximum Ratings

T_{amb} = 25°C, unless otherwise specified

Parameter	Test conditions	Symbol	Value	Unit
Forward current (DC)		I _F	35	mA

Optical and Electrical Characteristics

T_{amb} = 25°C, unless otherwise specified

Parameter	Test conditions	Symbol	Min	Typ	Max	Unit
Forward voltage	I _F = 20 mA	V _F		2.2	2.4	V
Reverse voltage	I _R = 100 µA	V _R	5			V
Radiant power	I _F = 20 mA	Φ _e	150	240		µW
Luminous intensity	I _F = 20 mA	I _v	30	45		mcd
Peak wavelength	I _F = 20 mA	λ _p		595		nm
Spectral bandwidth at 50%	I _F = 20 mA	Δλ _{0.5}		24		nm

Labeling

Type	Lot N°	Φ _e (min, typ), V _F (typ, max)	Quantity
ELC-595-29-5			

Packing: expanded Chips on adhesive film with wire-bond side on top