

# BIAS TEE

## HB Series



### Features

#### 1. Cuts DC and Supplies Voltage

Without affecting the high frequency characteristics, these bias tee can supply a DC bias (of 50 V, 2.5 A max.) to the item being measured.

#### 2. Coupling Portion Uses SMA Connectors

SMA connectors (Hirose Electric HRM Series, 50Ω impedance Z) are used in the coupling portion.

#### 3. Ensure a Wide Bandwidth and High Performance

The specification frequency shows a wide bandwidth of 500 MHz to 1800 MHz and there is a low insertion loss of 0.3 dB or less.

### Product Standards

Rating	Frequency range	500 to 1800 MHz	Operating temperature range Operating relative humidity	-10°C to +65°C 95% or less
	Characteristic impedance	50Ω		
	Maximum usable power (Total input power)	1 W		

### Materials

Part	Material	Processing
External cladding	Aluminum	Conductive alumite
Contact external cladding	Stainless steel	Passivated
Female contact	Beryllium copper	Gold plating

### External Dimensions

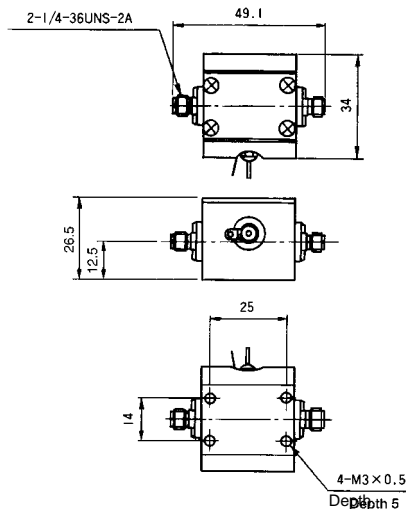

### Product Number Breakdown

#### HB - HRM - JJ

①      ②      ③

① Series Name: HB
② Type of Connector SMA (Hirose Electric HRM Series)
③ Connector Coupling Portion Jack - Jack

### Specifications

Model No.	Function	Connectors	Schematic	(MHz) Frequency Range	V.S.W.R. (Max)	(dB Max) Insertion Loss	(W) Power	(g) Weight
HB-HRM-JJ	BIAS-TEE	HRM Jack / HRM Jack		800~1,200 500~1,800	1.1 1.2	0.3	1	60

### Typical Data

